

Setting your TruCatch Trap to manually catch an animal

1. Begin by setting the Trucatch Trap as you normally would, by first raising the rings of the front door and lifting the door to the upright position.

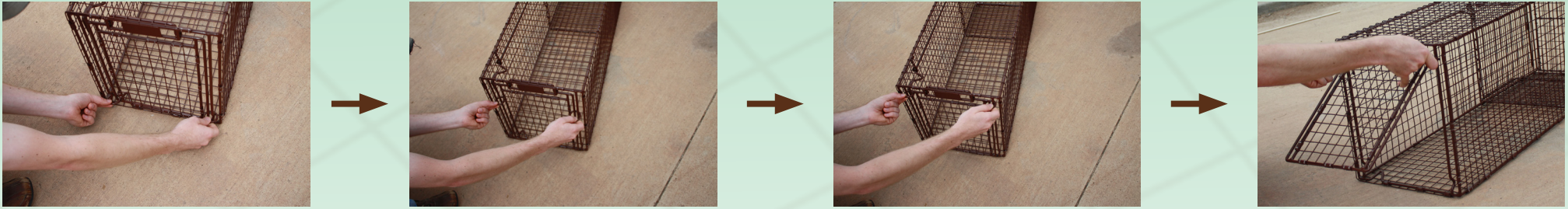

2. For the trap to be set off manually you will need a wooden dowel with a string tied to it. This will enable you to close the trap door from a distance.

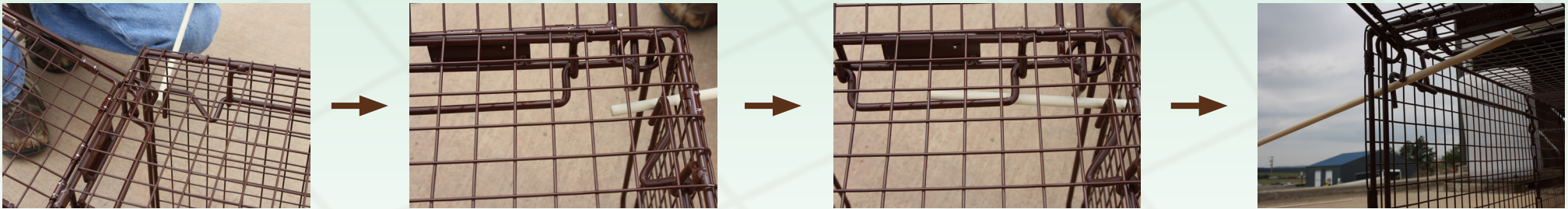

3. Now, instead of setting the adjustable trigger rod, run the wooden dowel through the cage wire on the left (trigger) side of the trap. The dowel should run behind the fixed trigger rod and wedged slightly underneath the top of the door frame, as it appears in its raised position.



When the animal(s) enter the trap, pull the string to release the dowel and the trap door will close. You can then release the animal(s) by raising the rear sliding door, or by rolling the trap over to make the front door fall open.